



## C10C SSMC/Male Termination 10 GHZ

Rev 000

<b>Electrical</b>	
Frequency	0-10 GHZ
VSWR	1.25 Max
Impedance	50 Ohms
Power Handling	1 Watt Average
<b>Mechanical</b>	
SSMC Interface per	MIL-STD-348B
Operating Temperature	-45°C to +120°C
<b>Materials</b>	
Body	Passivated Stainless Steel
Contacts	BeCu
Contact Plating	Au
Dielectric	PTFE
ROHS Compliant	



### Outline

5/32"  
HEX

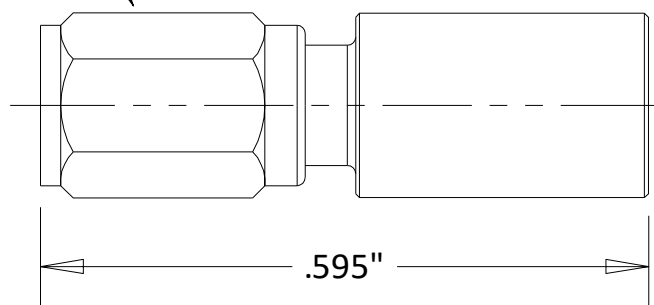

Dimensional Tolerances

.X	±.030
.XX	±.010
.XXX	±.005