



## C3649 N/Female to SMA/Female Flange Adapter 11 GHZ

Rev 001

<b>Electrical</b>	
Frequency	0-11 GHZ
VSWR	1.20
Impedance	50 Ohms
<b>Mechanical</b>	
N & SMA Interface per	MIL-STD-348B
Operating Temperature	-45°C to +120°C
<b>Materials</b>	
Body	Nickel Plated Brass
Contacts	BeCu
Contact Plating	Au 30μ" Min
Dielectric	PTFE
ROHS Compliant	



### Outline

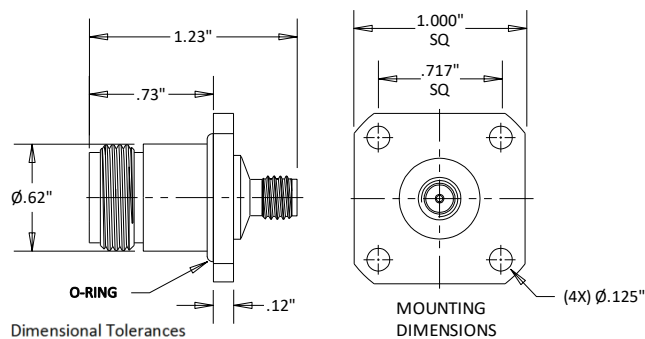

Dimensional Tolerances	
.X	$\pm .030$
.XX	$\pm .010$
.XXX	$\pm .005$

### Typical Data

