



## C4862 SMA/Female Coaxial Short 18 GHZ

Rev 000

<b>Electrical</b>	
Frequency	0-18 GHZ
<b>Mechanical</b>	
SMA Interface per	MIL-STD-348B
Operating Temperature	-65°C to +165°C
<b>Materials</b>	
Body	Passivated Stainless Steel
Contacts	BeCu per ASTM-B-196
Contact Plating	Au Per MIL-G-45204
Dielectric	PTFE per ASTM-D-1710
ROHS Compliant	



### Outline

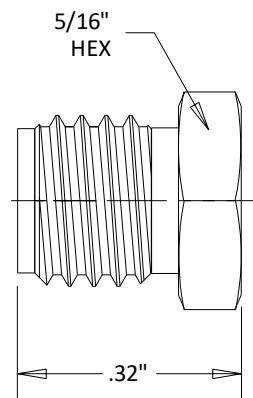

#### Dimensional Tolerances

.X	±.030
.XX	±.010
.XXX	±.005