



C8037 1.0/Male to 1.0/Male Adapter 110 GHZ

Rev 001

Electrical	
Frequency	0-110 GHZ
VSWR	1.25 Max
Impedance	50 Ohms
Mechanical	
1.0 Interface per	IEC-61169-31
Operating Temperature	-45°C to +85°C
Materials	
Body	Passivated Stainless Steel
Contacts	BeCu
Contact Plating	Au 50μ" Min
ROHS Compliant	



Outline

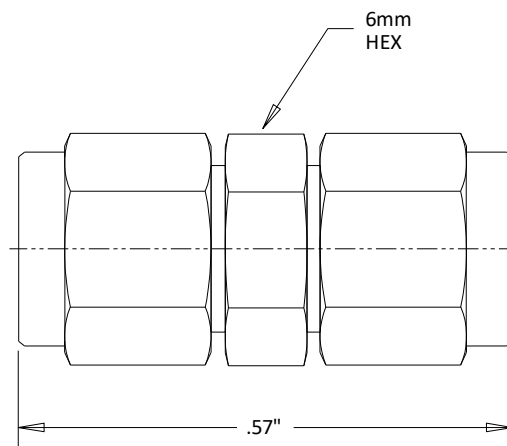

Dimensional Tolerances

.X	±.030
.XX	±.010
.XXX	±.005