



## CS18SR5M SMA Female/Male/Female Resistive Power Divider 18 GHZ

Rev 000

<b>Electrical</b>	
Frequency	0-18 GHZ
VSWR	1.20
Impedance	50 Ohms
Insertion Loss	6.5 dB Max(S12, S13, & S23)
Power Handling	5 W Average; De-rated linearly to 0.5W @ 100°C
<b>Mechanical</b>	
SMA Interface per	MIL-STD-348B
Operating Temperature	-55° to +100°C
<b>Materials</b>	
Body(Connectors)	Passivated Stainless Steel
Housing	Passivated Stainless Steel
Contacts	BeCu
Contact Plating	Au 50μ" Min
ROHS Compliant	



### Outline

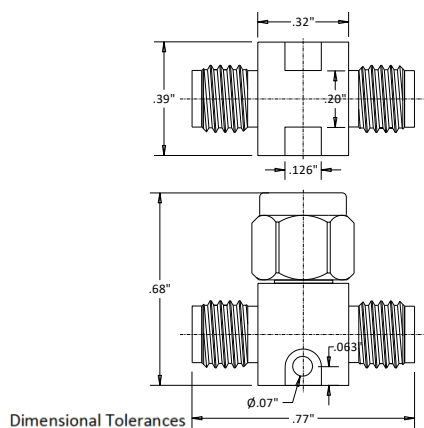

### Typical Data

