



## CWR75NC N/Female to WR75 Waveguide to Coax Adapter

Rev 000

<b>Electrical</b>	
Frequency	10-15 GHz
VSWR	1.20
Impedance	50 Ohms
<b>Mechanical</b>	
N Interface per	MIL-STD-348B
<b>Materials</b>	
Body(N)	Passivated Stainless Steel
Body	Al/Cu
Contacts(N)	Brass
Contact Plating	Au



### Outline

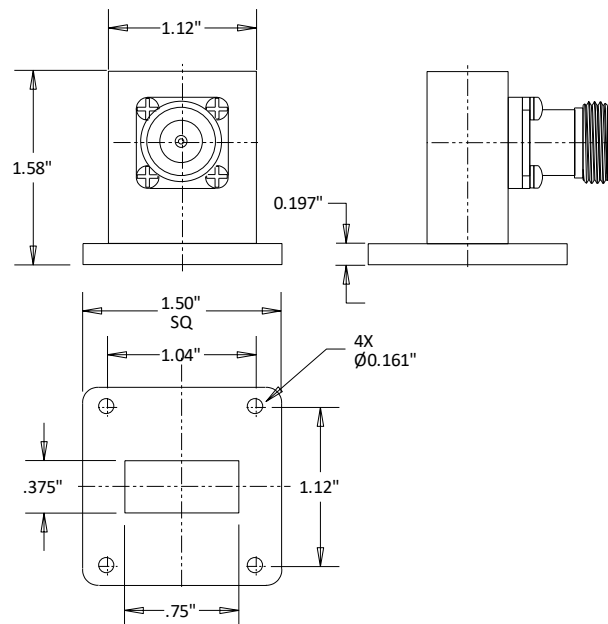

#### Dimensional Tolerances

.X	±.030
.XX	±.010
.XXX	±.005