



## CWR90SB SMA/Female to WR90 Coaxial to Waveguide Adapter 8.2-12.4 GHz

Rev 001

<b>Electrical</b>	
Frequency	8.2-12.4 GHz
VSWR	1.25
Impedance	50 Ohms
<b>Mechanical</b>	
SMA Interface per	MIL-STD-348B
<b>Materials</b>	
Body	Al/Cu
Body(SMA)	Passivated Stainless Steel
Contact	BeCu
Contact Plating	Au
Dielectric	PTFE



### Outline

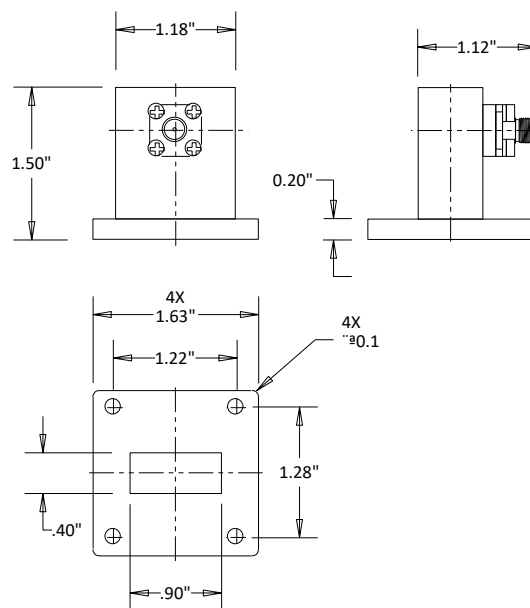

#### Dimensional Tolerances

.X	$\pm 0.030$
.XX	$\pm 0.010$
.XXX	$\pm 0.005$