



## CWRD200NB N/Female to WRD200 Coaxial to Waveguide Adapter 2.0-4.8 GHZ

Rev 001

<b>Electrical</b>	
Frequency	2.0-4.8 GHZ
VSWR	1.30 Max
Impedance	50 Ohms
<b>Mechanical</b>	
N Interface per	MIL-STD-348B
<b>Materials</b>	
Body	Al
Body(N)	Passivated Stainless Steel
Contact	BeCu
Contact Plating	Au 50μ" Min



### Outline

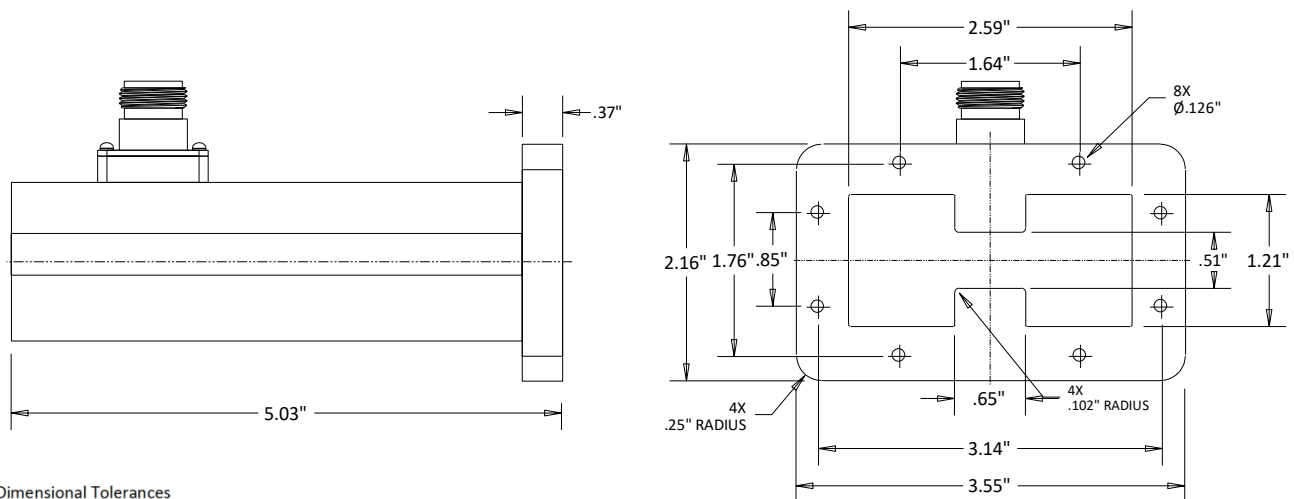

#### Dimensional Tolerances

.X	±.030
.XX	±.010
.XXX	±.005