



## CX0471 SMA/Male Connector for .047 27 GHZ

Rev 000

<b>Electrical</b>	
Frequency	0-27 GHZ
Impedance	50 Ohms
<b>Mechanical</b>	
SMA Interface per	MIL-STD-348B
<b>Materials</b>	
Body	Passivated Stainless Steel
Contacts	Brass
Contact Plating	Au Per MIL-G-45204
ROHS Compliant	



### Outline

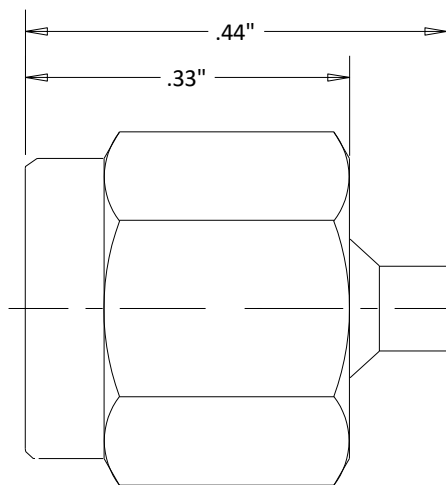

Dimensional Tolerances

.X	±.030
.XX	±.010
.XXX	±.005

### STRIPPING DIMENSIONS

