



CX2921 2.92/Male Connector for RG405(.086) 40 GHZ

Rev 000

Electrical	
Frequency	0-40 GHZ
Impedance	50 Ohms
Mechanical	
2.92 Interface per	MIL-STD-348B
Materials	
Body	Passivated Stainless Steel
Contacts	BeCu
Contact Plating	Au 50 μ " Min
ROHS Compliant	



Outline

CONNECTOR BODY

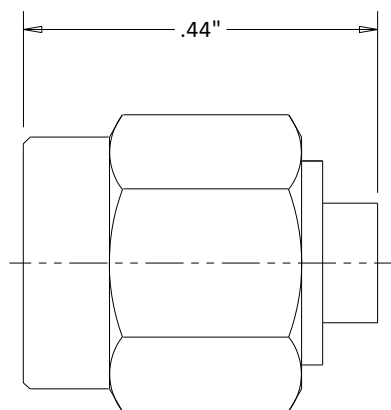

SOLDER PIN

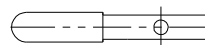

SUPPORT BEAD

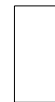

Dimensional Tolerances

.X	± 0.30
.XX	± 0.10
.XXX	± 0.05